



**AVM TIMING PULLEY PVT. LTD.**  
(formerly known as Ultrahigh (india) Engineers)



**AVM BRAND  
TIMING PULLEY**

**MANUFACTURER | SUPPLIER | EXPORTER**  
**OF TAPER LOCK TIMING PULLEY**

[www.avmtimingpulley.com](http://www.avmtimingpulley.com)

**TAPER LOCK BUSH TIMING PULLEY**

5MM PITCH TAPER LOCK TIMING PULLEY.....	1
8MM PITCH TAPER LOCK TIMING PULLEY.....	2-5
14MM PITCH TAPER LOCK TIMING PULLEY.....	6-9
L(3/8") PITCH TAPER LOCK TIMING PULLEY.....	10-12
H(1/2") PITCH TAPER LOCK TIMING PULLEY.....	13-16



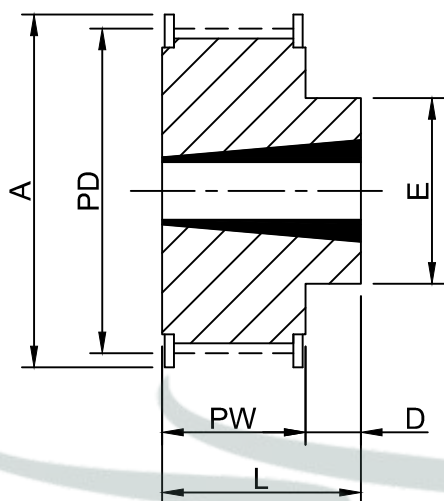

**TYPE 2F**

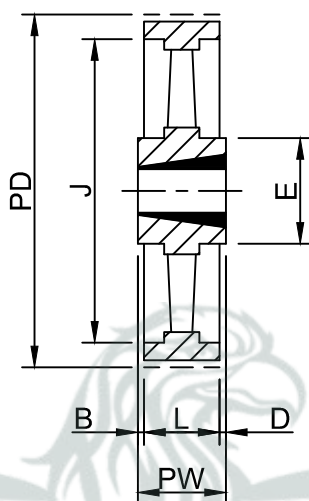

**TYPE 10**

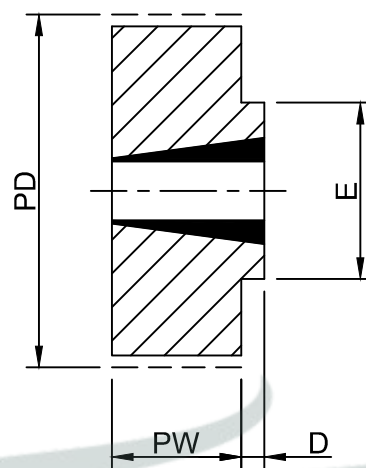

**TYPE 11**

## TECHNICAL SPECIFICATIONS

### 5mm Pitch Timing Pulleys For 15mm Wide Belts Ref. 5M 15

PART NO.	PULLEY SIZE	PULLEY TYPE	BUSH NO	MATERIAL	NO. OF TEETH	MAX BORE (MB)	PD	A	PW	J	B	L	D	E	APPROX WEIGHT (kg)
N0591	34-5M-15	2F	1008	C.I. / FG200	34	25	54.11	57	22	-	-	22	-	-	0.23
N0592	36-5M-15	2F	1108	C.I. / FG200	36	28	57.30	60	22	-	-	22	-	-	0.23
N0593	38-5M-15	2F	1108	C.I. / FG200	38	28	60.48	67	22	-	-	22	-	-	0.29
N0594	40-5M-15	2F	1108	C.I. / FG200	40	28	63.66	71	22	-	-	22	-	-	0.38
N0595	44-5M-15	2F	1108	C.I. / FG200	44	28	70.03	75	22	-	-	22	-	-	0.48
N0596	48-5M-15	2F	1210	C.I. / FG200	48	32	76.39	83	22	-	-	25	3	59	0.50
N0597	56-5M-15	2F	1210	C.I. / FG200	56	32	89.13	93	22	-	-	25	3	75	0.66
N0598	64-5M-15	2F	1210	C.I. / FG200	64	32	101.86	106	22	-	-	25	3	80	0.85
N0599	72-5M-15	11	1610	C.I. / FG200	72	42	114.59	-	22	-	-	25	3	92	1.25
N0600	80-5M-15	11	1610	C.I. / FG200	80	42	127.32	-	22	-	-	25	3	92	1.70
N0601	90-5M-15	10	1610	C.I. / FG200	90	42	143.24	-	22	126	-	25	3	92	2.25
N0602	112-5M-15	10	2012	C.I. / FG200	112	50	178.25	-	22	160	-	32	10	110	3.20
N0603	136-5M-15	10	2012	C.I. / FG200	136	50	216.45	-	22	199	-	32	10	110	3.60

Please note all dimensions are in mm

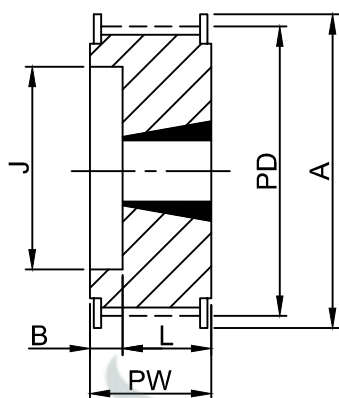

**TYPE 4F**

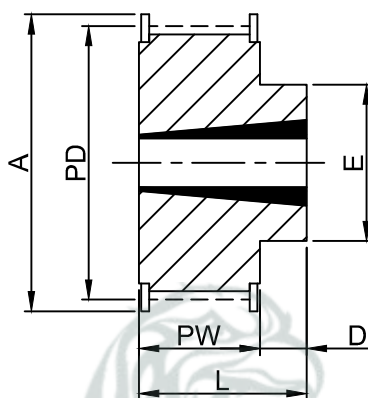

**TYPE 2F**

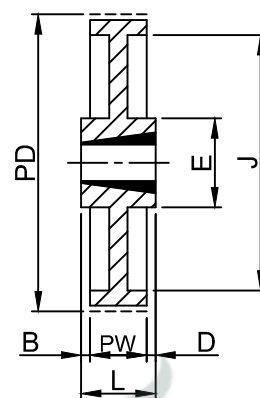

**TYPE 9**

## TECHNICAL SPECIFICATIONS

### 8mm Pitch Timing Pulleys For 20mm Wide Belts Ref. 8M 20

PART NO.	PULLEY SIZE	PULLEY TYPE	BUSH NO	MATERIAL	NO. OF TEETH	MAX BORE (MB)	PD	A	PW	J	B	L	D	E	APPROX WEIGHT (kg)
N0604	22-8M-20	4F	1108	C.I. / FG200	22	25	56.02	60	28	37	6	22	-	-	0.26
N0605	24-8M-20	4F	1108	C.I. / FG200	24	28	61.12	66	28	44	6	22	-	-	0.30
N0606	26-8M-20	4F	1108	C.I. / FG200	26	28	66.21	70	28	45	6	22	-	-	0.36
N0607	28-8M-20	4F	1108	C.I. / FG200	28	28	71.30	75	28	50	6	22	-	-	0.44
N0608	30-8M-20	4F	1108	C.I. / FG200	30	28	76.39	83	28	58	6	22	-	-	0.53
N0609	32-8M-20	4F	1610	C.I. / FG200	32	42	81.49	87	28	63	3	25	-	-	0.42
N0610	34-8M-20	4F	1610	C.I. / FG200	34	42	86.58	91	28	64	3	25	-	-	0.55
N0611	36-8M-20	4F	1610	C.I. / FG200	36	42	91.67	97	28	68	3	25	-	-	0.68
N0612	38-8M-20	4F	1610	C.I. / FG200	38	42	96.77	102	28	72	3	25	-	-	0.80
N0613	40-8M-20	4F	1610	C.I. / FG200	40	42	101.86	106	28	76	3	25	-	-	1.00
N0614	44-8M-20	4F	2012	C.I. / FG200	44	50	112.05	120	28	-	-	32	4.00	92	1.20
N0615	48-8M-20	4F	2012	C.I. / FG200	48	50	122.23	128	28	-	-	32	4.00	96	1.60
N0616	56-8M-20	4F	2012	C.I. / FG200	56	50	142.60	150	28	-	-	32	4.00	110	2.40
N0617	64-8M-20	4F	2012	C.I. / FG200	64	50	162.97	168	28	-	-	32	4.00	110	2.70
N0618	72-8M-20	4F	2012	C.I. / FG200	72	50	183.35	192	28	-	-	32	4.00	110	3.30
N0619	80-8M-20	9	2021	C.I. / FG200	80	50	203.72	-	28	180	-	32	4.00	110	3.50
N0620	90-8M-20	9	2021	C.I. / FG200	90	50	229.18	-	28	204	-	32	4.00	110	3.65

Please note all dimensions are in mm

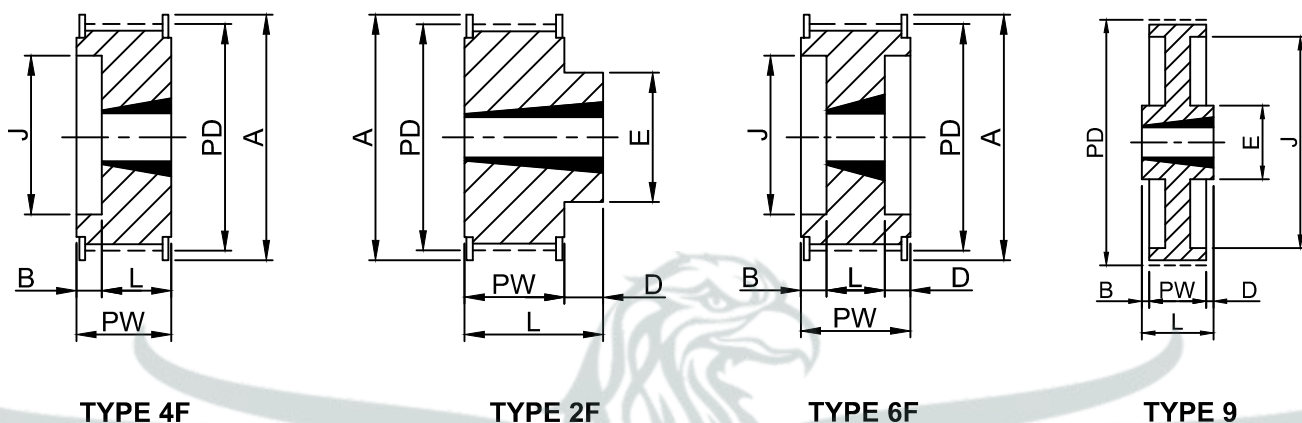

## TECHNICAL SPECIFICATIONS

### 8mm Pitch Timing Pulleys For 30mm Wide Belts Ref. 8M 30

PART NO.	PULLEY SIZE	PULLEY TYPE	BUSH NO	MATERIAL	NO. OF TEETH	MAX BORE (MB)	PD	A	PW	J	B	L	D	E	APPROX WEIGHT (kg)
N0621	22-8M-30	4F	1108	C.I. / FG200	22	25	56.02	60	38	37	16	22	-	-	0.32
N0622	24-8M-30	4F	1108	C.I. / FG200	24	28	61.12	66	38	44	16	22	-	-	0.38
N0623	26-8M-30	4F	1108	C.I. / FG200	26	28	66.21	70	38	44	16	22	-	-	0.45
N0624	28-8M-30	4F	1210	C.I. / FG200	28	32	71.30	75	38	50	13	25	-	-	0.50
N0625	30-8M-30	2F	1615	C.I. / FG200	30	42	76.39	83	38	-	-	38	-	-	0.55
N0626	32-8M-30	2F	1615	C.I. / FG200	32	42	81.49	87	38	-	-	38	-	-	0.59
N0627	34-8M-30	2F	1615	C.I. / FG200	34	42	86.58	91	38	-	-	38	-	-	0.77
N0628	36-8M-30	2F	1615	C.I. / FG200	36	42	91.67	97	38	-	-	38	-	-	0.96
N0629	38-8M-30	2F	1615	C.I. / FG200	38	42	96.77	102	38	-	-	38	-	-	1.15
N0630	40-8M-30	2F	1615	C.I. / FG200	40	42	101.86	106	38	-	-	38	-	-	1.34
N0631	44-8M-30	4F	2012	C.I. / FG200	44	50	112.05	120	38	-	6	32	-	-	1.33
N0632	48-8M-30	4F	2012	C.I. / FG200	48	50	122.23	128	38	-	6	32	-	-	1.78
N0633	56-8M-30	6F	2012	C.I. / FG200	56	50	142.60	150	38	-	3	32	3	-	3.76
N0634	64-8M-30	2F	2517	C.I. / FG200	64	60	162.97	168	38	-	-	45	7	125	4.20
N0635	72-8M-30	2F	2517	C.I. / FG200	72	60	183.35	192	38	-	-	45	7	125	4.30
N0636	80-8M-30	9	2517	C.I. / FG200	80	60	203.72	-	38	180	-	45	7	125	4.60
N0637	90-8M-30	9	2517	C.I. / FG200	90	60	229.18	-	38	204	-	45	7	125	5.00
N0638	112-8M-30	9	2517	C.I. / FG200	112	60	285.21	-	38	204	-	45	7	125	6.20
N0639	144-8M-30	8	2517	C.I. / FG200	144	60	366.69	-	38	336	-	45	7	125	9.00

Please note all dimensions are in mm

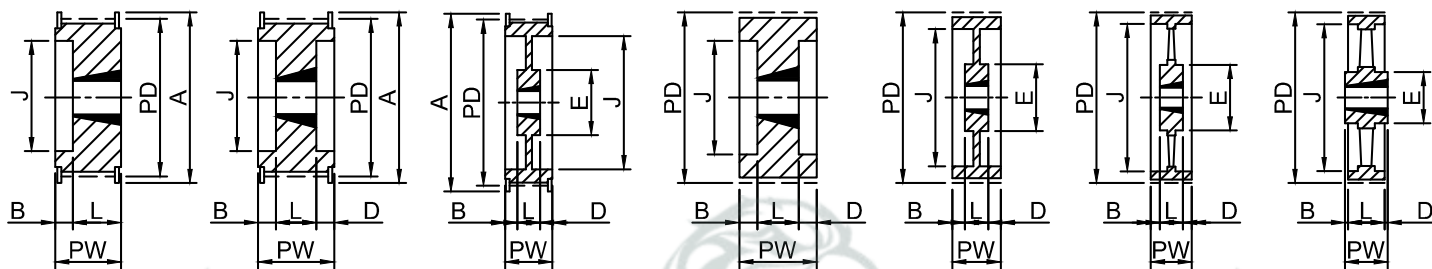

**TYPE 4F**

**TYPE 6F**

**TYPE 7F**

**TYPE 6**

**TYPE 7**

**TYPE 8**

**TYPE 10**

## TECHNICAL SPECIFICATIONS

### 8mm Pitch Timing Pulleys For 50mm Wide Belts Ref. 8M 50

PART NO.	PULLEY SIZE	PULLEY TYPE	BUSH NO	MATERIAL	NO. OF TEETH	MAX BORE (MB)	PD	A	PW	J	B	L	D	E	APPROX WEIGHT (kg)
N0640	28-8M-50	4F	1210	C.I. / FG200	28	32	71.30	75	60	50	35	25	-	-	0.60
N0641	30-8M-50	4F	1615	C.I. / FG200	30	42	76.39	83	60	58	22	38	-	-	0.65
N0642	32-8M-50	4F	1615	C.I. / FG200	32	42	81.49	87	60	63	22	38	-	-	0.82
N0643	34-8M-50	4F	1615	C.I. / FG200	34	42	86.58	91	60	65	22	38	-	-	1.06
N0644	36-8M-50	4F	1615	C.I. / FG200	36	42	91.67	97	60	68	22	38	-	-	1.30
N0645	38-8M-50	4F	1615	C.I. / FG200	38	42	96.77	102	60	72	22	38	-	-	1.60
N0646	40-8M-50	6F	2012	C.I. / FG200	40	50	101.86	106	60	80	14	32	14	-	1.71
N0647	44-8M-50	6F	2012	C.I. / FG200	44	50	112.05	120	60	86	14	32	14	-	1.78
N0648	48-8M-50	6F	2012	C.I. / FG200	48	50	122.23	128	60	95	14	32	14	-	2.30
N0649	56-8M-50	6F	2517	C.I. / FG200	56	60	142.60	150	60	116	7.5	45	7.5	-	3.40
N0650	64-8M-50	6F	2517	C.I. / FG200	64	60	162.97	168	60	136	7.5	45	7.5	-	5.00
N0651	72-8M-50	7F	2517	C.I. / FG200	72	60	183.35	192	60	158	7.5	45	7.5	125	6.70
N0652	80-8M-50	6	3020	C.I. / FG200	80	75	203.72	-	60	180	4.5	51	4.5	-	8.80
N0653	90-8M-50	7	3020	C.I. / FG200	90	75	229.18	-	60	204	4.5	51	4.5	160	10.00
N0654	112-8M-50	7	3020	C.I. / FG200	112	75	285.21	-	60	254	4.5	51	4.5	170	12.00
N0655	144-8M-50	8	3020	C.I. / FG200	144	75	366.96	-	60	336	4.5	51	4.5	170	15.20
N0656	168-8M-50	10	3525	C.I. / FG200	168	100	472.81	-	60	395	2.5	65	2.5	198	17.50
N0657	192-8M-50	10	3525	C.I. / FG200	192	100	488.92	-	60	455	2.5	65	2.5	198	24.00

Please note all dimensions are in mm

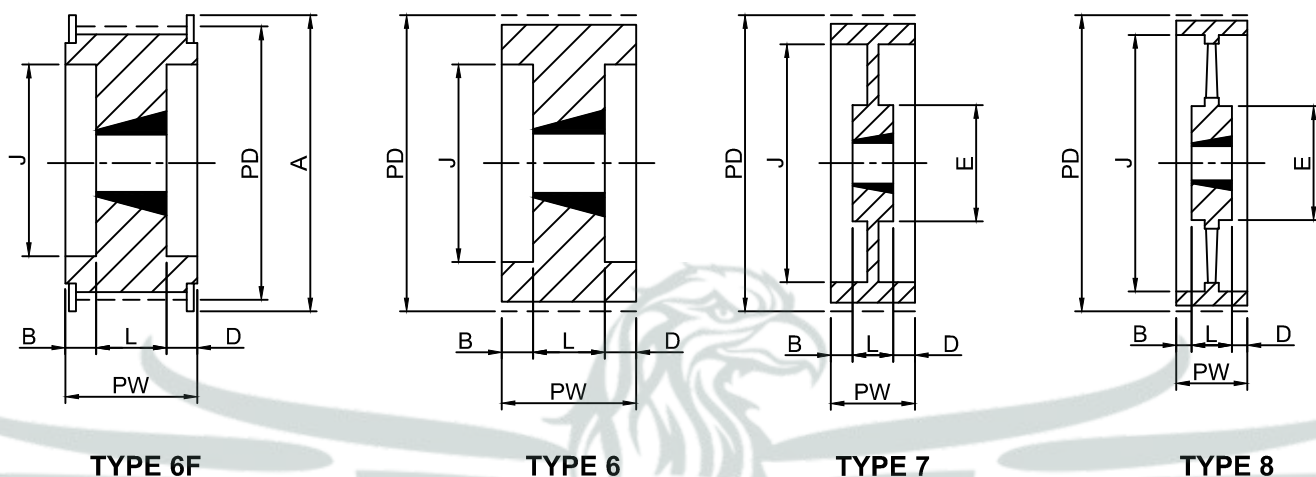

## TECHNICAL SPECIFICATIONS

### 8mm Pitch Timing Pulleys For 85mm Wide Belts Ref. 8M 85

PART NO.	PULLEY SIZE	PULLEY TYPE	BUSH NO	MATERIAL	NO. OF TEETH	MAX BORE (MB)	PD	A	PW	J	B	L	D	E	APPROX WEIGHT (kg)
N0658	34-8M-85	6F	1615	C.I. / FG200	34	42	86.58	75	95	65	28	38	28	-	1.43
N0659	36-8M-85	6F	1615	C.I. / FG200	36	42	91.67	83	95	68	28	38	28	-	1.87
N0660	38-8M-85	6F	1615	C.I. / FG200	38	42	96.77	87	95	72	28	38	28	-	2.20
N0661	40-8M-85	6F	2012	C.I. / FG200	40	50	101.86	91	95	80	31	32	31	-	2.80
N0662	44-8M-85	6F	2012	C.I. / FG200	44	50	112.05	97	95	86	31	32	31	-	2.30
N0663	48-8M-85	6F	2517	C.I. / FG200	48	60	122.23	102	95	97	25	45	25	-	2.66
N0664	56-8M-85	6F	2517	C.I. / FG200	56	60	142.60	106	95	116	25	45	25	-	4.45
N0665	64-8M-85	6F	2517	C.I. / FG200	64	60	162.97	120	95	136	25	45	25	-	6.20
N0666	72-8M-85	6F	3020	C.I. / FG200	72	75	183.35	128	95	150	22	51	22	-	8.00
N0667	80-8M-85	6	3020	C.I. / FG200	80	75	203.72	-	95	180	22	51	22	-	10.00
N0668	90-8M-85	6	3020	C.I. / FG200	90	75	229.18	-	95	204	22	51	22	-	10.80
N0669	112-8M-85	7	3020	C.I. / FG200	112	75	285.21	-	95	254	22	51	22	170	15.00
N0670	144-8M-85	7	3020	C.I. / FG200	144	100	366.69	-	95	336	15	65	15	198	20.00
N0671	168-8M-85	8	3525	C.I. / FG200	168	100	427.81	-	95	395	15	65	15	198	22.00
N0672	192-8M-85	8	3525	C.I. / FG200	192	100	488.92	-	95	455	15	65	15	498	26.00

Please note all dimensions are in mm

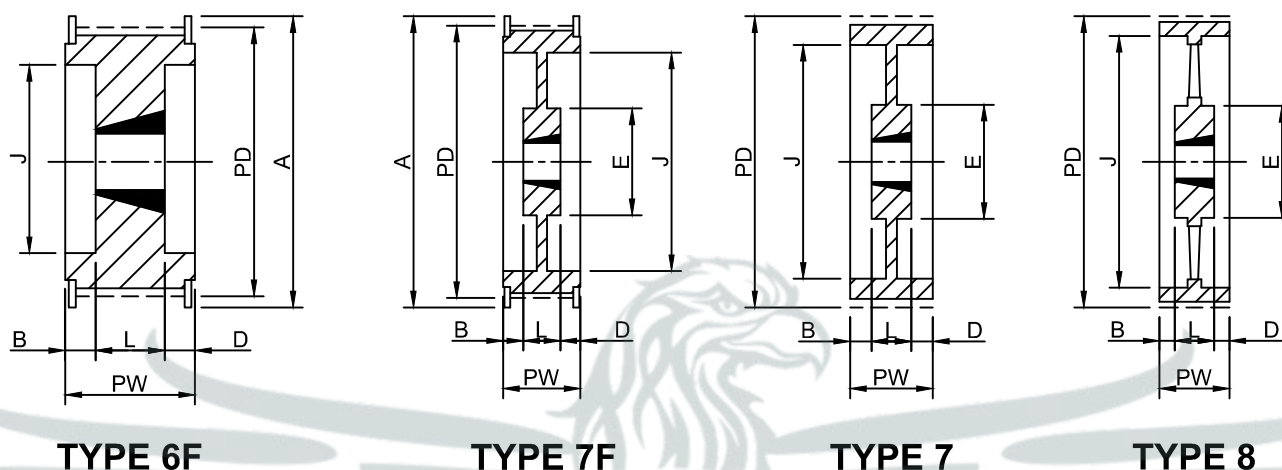

## TECHNICAL SPECIFICATIONS

### 14mm Pitch Timing Pulleys For 40mm Wide Belts Ref. 14M 40

PART NO.	PULLEY SIZE	PULLEY TYPE	BUSH NO	MATERIAL	NO. OF TEETH	MAX BORE (MB)	PD	A	PW	J	B	L	D	E	APPROX WEIGHT (kg)
N0673	28-14M-40	6F	2012	C.I. / FG200	28	50	124.78	128	54	94	11	32	11	-	2.07
N0674	29-14M-40	6F	2012	C.I. / FG200	29	50	129.23	138	54	98	11	32	11	-	2.30
N0675	30-14M-40	6F	2012	C.I. / FG200	30	50	133.69	138	54	98	11	32	11	-	2.65
N0676	32-14M-40	6F	2012	C.I. / FG200	32	50	142.60	154	54	108	11	32	11	-	3.40
N0677	34-14M-40	6F	2517	C.I. / FG200	34	60	151.51	160	54	120	4.5	45	4.5	-	4.80
N0678	36-14M-40	6F	2517	C.I. / FG200	36	60	160.43	168	54	120	4.5	45	4.5	-	4.80
N0679	38-14M-40	6F	2517	C.I. / FG200	38	60	169.34	184	54	130	4.5	45	4.5	-	5.40
N0680	40-14M-40	6F	2517	C.I. / FG200	40	60	178.25	188	54	138	4.5	45	4.5	-	6.00
N0681	44-14M-40	6F	3020	C.I. / FG200	44	75	196.08	212	54	155	1.5	51	1.5	-	7.80
N0682	48-14M-40	6F	3020	C.I. / FG200	48	75	213.90	226	54	170	1.5	51	1.5	-	9.40
N0683	56-14M-40	6F	3020	C.I. / FG200	56	75	249.55	256	54	208	1.5	51	1.5	-	10.80
N0684	64-14M-40	7F	3020	C.I. / FG200	64	75	285.21	296	54	240	1.5	51	1.5	170	13.40
N0685	72-14M-40	7	3020	C.I. / FG200	72	75	401.07	-	54	360	1.5	51	1.5	170	17.80
N0686	80-14M-40	8	3020	C.I. / FG200	80	75	356.51	-	54	315	1.5	51	1.5	170	16.00
N0687	90-14M-40	8	3020	C.I. / FG200	90	75	401.07	-	54	360	1.5	51	1.5	170	17.80
N0688	112-14M-40	8	3020	C.I. / FG200	112	75	499.11	-	54	457	1.5	51	1.5	170	25.60
N0689	144-14M-40	8	3020	C.I. / FG200	144	75	641.71	-	54	600	1.5	51	1.5	170	32.00
N0690	168-14M-40	8	3020	C.I. / FG200	168	75	748.66	-	54	706	1.5	51	1.5	170	44.00
N091	192-14M-40	8	3020	C.I. / FG200	192	75	855.62	-	54	813	1.5	51	1.5	170	49.00

Please note all dimensions are in mm



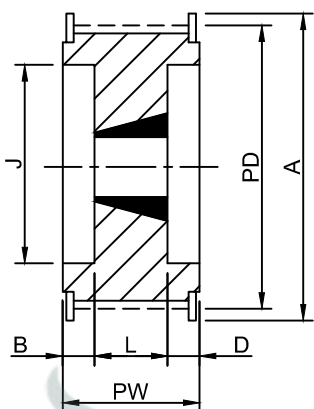

**TYPE 6F**

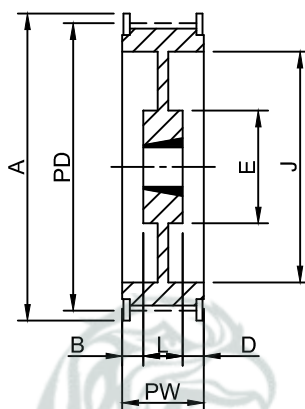

**TYPE 7F**

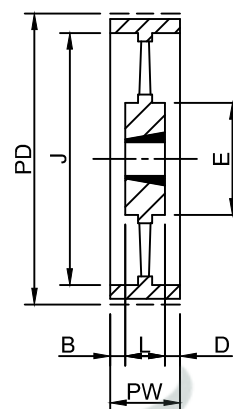

**TYPE 8**

## TECHNICAL SPECIFICATIONS

### 14mm Pitch Timing Pulleys For 55mm Wide Belts Ref. 14M 55

PART NO.	PULLEY SIZE	PULLEY TYPE	BUSH NO	MATERIAL	NO. OF TEETH	MAX BORE (MB)	PD	A	PW	J	B	L	D	E	APPROX WEIGHT (kg)
N0692	28-14M-55	6F	2012	C.I. / FG200	28	50	124.78	128	70	94	19	32	19	-	2.20
N0693	29-14M-55	6F	2012	C.I. / FG200	29	50	129.23	138	70	98	19	32	19	-	2.50
N0694	30-14M-55	6F	2517	C.I. / FG200	30	60	133.69	138	70	100	12.5	45	12.5	-	2.70
N0695	32-14M-55	6F	2517	C.I. / FG200	32	60	142.60	154	70	108	12.5	45	12.5	-	3.60
N0696	34-14M-55	6F	2517	C.I. / FG200	34	60	151.51	160	70	110	12.5	45	12.5	-	4.55
N0697	36-14M-55	6F	2517	C.I. / FG200	36	60	160.43	168	70	120	12.5	45	12.5	-	5.20
N0698	38-14M-55	6F	2517	C.I. / FG200	38	60	169.34	184	70	130	12.5	45	12.5	-	6.20
N0699	40-14M-55	6F	2517	C.I. / FG200	40	60	178.25	188	70	138	12.5	45	12.5	-	7.00
N0700	44-14M-55	6F	3020	C.I. / FG200	44	75	196.08	212	70	155	9.5	51	9.5	-	8.60
N0701	48-14M-55	6F	3020	C.I. / FG200	48	75	213.90	226	70	170	9.5	51	9.5	-	10.40
N0702	56-14M-55	6F	3020	C.I. / FG200	56	75	249.55	256	70	208	9.5	51	9.5	-	12.40
N0703	64-14M-55	7F	3020	C.I. / FG200	64	75	285.21	296	70	240	9.5	51	9.5	170	14.50
N0704	72-14M-55	8	3020	C.I. / FG200	72	75	320.86	-	70	280	9.5	51	9.5	170	16.20
N0705	80-14M-55	8	3020	C.I. / FG200	80	75	356.51	-	70	315	9.5	51	9.5	170	17.50
N0706	90-14M-55	8	3020	C.I. / FG200	90	75	401.07	-	70	360	9.5	51	9.5	170	20.10
N0707	112-14M-55	8	3020	C.I. / FG200	112	75	499.11	-	70	457	9.5	51	9.5	170	28.40
N0708	144-14M-55	8	3020	C.I. / FG200	144	75	641.71	-	70	600	9.5	51	9.5	170	36.20
N0709	168-14M-55	8	3020	C.I. / FG200	168	75	748.66	-	70	706	9.5	51	9.5	170	49.00
N0710	192-14M-55	8	3020	C.I. / FG200	192	75	855.62	-	70	813	9.5	51	9.5	170	53.00

Please note all dimensions are in mm

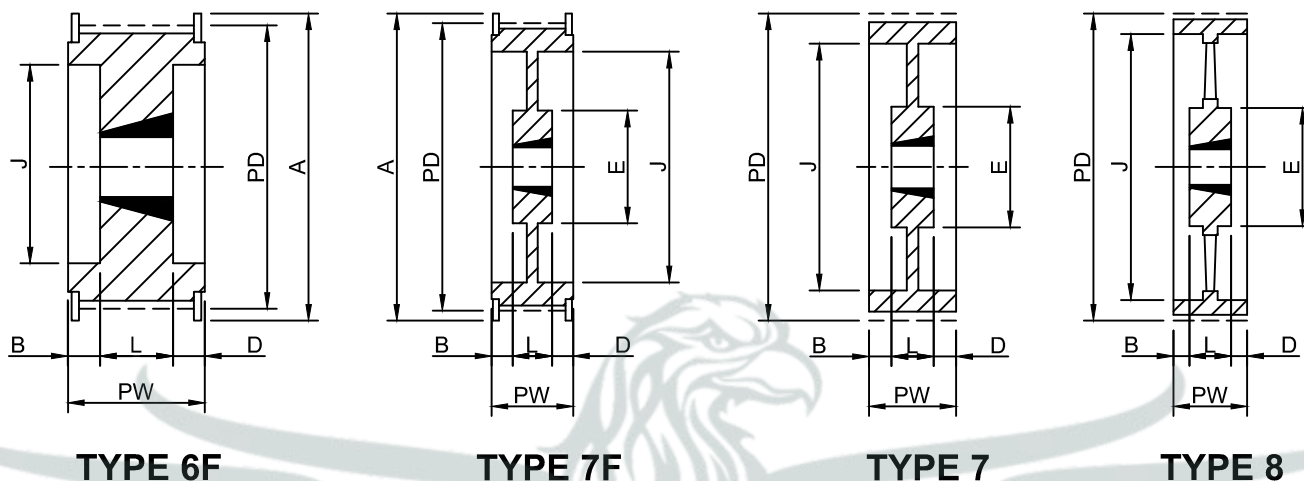

## TECHNICAL SPECIFICATIONS

### 14mm Pitch Timing Pulleys For 85mm Wide Belts Ref. 14M 85

PART NO.	PULLEY SIZE	PULLEY TYPE	BUSH NO	MATERIAL	NO. OF TEETH	MAX BORE (MB)	PD	A	PW	J	B	L	D	E	APPROX WEIGHT (kg)
N0711	28-14M-85	6F	2517	C.I. / FG200	28	60	124.78	128	102	98	28.5	45	28.5	-	2.70
N0712	29-14M-85	6F	2517	C.I. / FG200	29	60	129.23	138	102	98	28.5	45	28.5	-	3.00
N0713	30-14M-85	6F	2517	C.I. / FG200	30	60	133.69	138	102	100	28.5	45	28.5	-	3.75
N0714	32-14M-85	6F	2517	C.I. / FG200	32	60	142.60	154	102	108	28.5	45	28.5	-	4.80
N0715	34-14M-85	6F	2517	C.I. / FG200	34	60	151.51	160	102	110	28.5	45	28.5	-	6.00
N0716	36-14M-85	6F	3020	C.I. / FG200	36	75	160.43	168	102	125	25.5	51	25.5	-	6.33
N0717	38-14M-85	6F	3020	C.I. / FG200	38	75	169.34	184	102	130	25.5	51	25.5	-	6.80
N0718	40-14M-85	6F	3020	C.I. / FG200	40	75	178.25	188	102	138	25.5	51	25.5	-	8.00
N0719	44-14M-85	6F	3030	C.I. / FG200	44	75	169.08	212	102	155	13	76	13	-	11.80
N0720	48-14M-85	6F	3030	C.I. / FG200	48	75	213.90	226	102	155	13	76	13	-	15.10
N0721	56-14M-85	6F	3525	C.I. / FG200	56	100	249.55	256	102	210	18.5	65	18.5	-	19.00
N0722	64-14M-85	7F	3525	C.I. / FG200	64	100	185.21	296	102	240	18.5	65	18.5	178	23.00
N0723	72-14M-85	7	3525	C.I. / FG200	72	100	320.86	-	102	280	18.5	65	18.5	178	25.00
N0724	80-14M-85	7	3525	C.I. / FG200	80	100	356.51	-	102	315	18.5	65	18.5	178	26.00
N0725	90-14M-85	8	3525	C.I. / FG200	90	100	401.07	-	102	360	18.5	65	18.5	178	27.80
N0726	112-14M-85	8	3525	C.I. / FG200	112	100	499.11	-	102	457	18.5	65	18.5	178	36.50
N0727	144-14M-85	8	3525	C.I. / FG200	144	100	641.71	-	102	600	18.5	65	18.5	206	48.00
N0728	168-14M-85	8	3525	C.I. / FG200	168	100	748.66	-	102	706	18.5	65	18.5	206	60.00
N0729	192-14M-85	8	4040	C.I. / FG200	192	115	855.62	-	102	813	-	102	-	216	86.00

Please note all dimensions are in mm

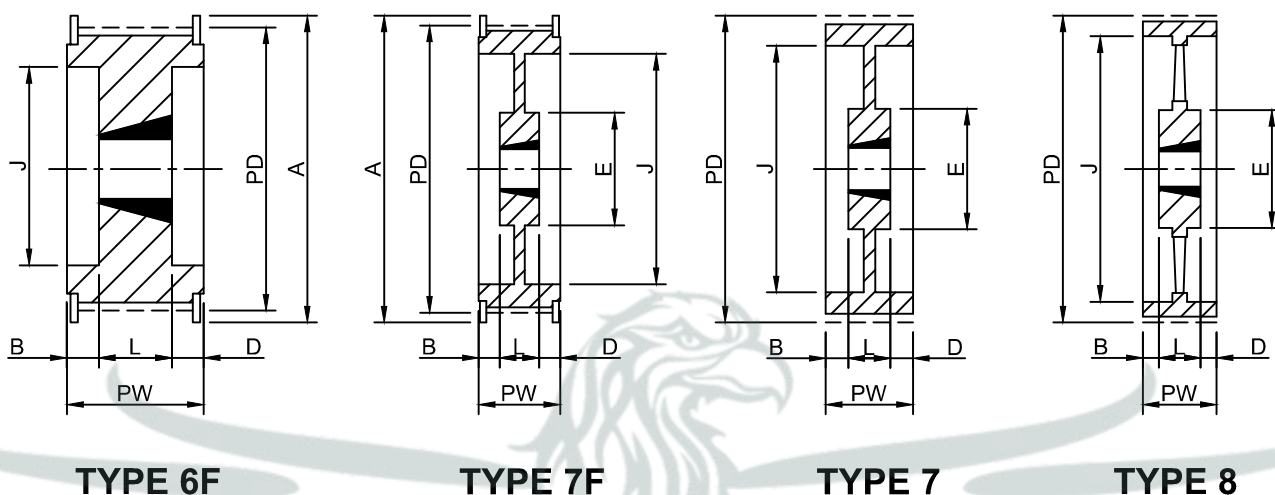

## TECHNICAL SPECIFICATIONS

### 14mm Pitch Timing Pulleys For 115mm Wide Belts Ref. 14M 115

PART NO.	PULLEY SIZE	PULLEY TYPE	BUSH NO	MATERIAL	NO. OF TEETH	MAX BORE (MB)	PD	A	PW	J	B	L	D	E	APPROX WEIGHT (kg)
N0730	28-14M-115	6F	2517	C.I. / FG200	28	60	124.78	128	133	98	44	45	44	-	3.77
N0731	29-14M-115	6F	2517	C.I. / FG200	29	60	129.23	138	133	98	44	45	44	-	4.40
N0732	30-14M-115	6F	2517	C.I. / FG200	30	60	133.69	138	133	100	44	45	44	-	5.00
N0733	32-14M-115	6F	2517	C.I. / FG200	32	60	142.60	154	133	108	44	45	44	-	6.80
N0734	34-14M-115	6F	2517	C.I. / FG200	34	60	151.51	160	133	110	44	45	44	-	8.00
N0735	36-14M-115	6F	3020	C.I. / FG200	36	75	160.43	168	133	125	41	51	41	-	8.40
N0736	38-14M-115	6F	3020	C.I. / FG200	38	75	169.34	184	133	130	41	51	41	-	8.70
N0737	40-14M-115	6F	3020	C.I. / FG200	40	75	178.25	188	133	138	41	51	41	-	9.20
N0738	44-14M-115	6F	3030	C.I. / FG200	44	75	196.08	212	133	155	28.5	76	28.5	-	14.00
N0739	48-14M-115	6F	3030	C.I. / FG200	48	75	213.90	226	133	170	28.5	76	28.5	-	17.10
N0740	56-14M-115	6F	3535	C.I. / FG200	56	90	249.55	256	133	210	22	89	22	-	24.80
N0741	64-14M-115	7F	3535	C.I. / FG200	64	90	285.21	296	133	240	22	89	22	190	27.00
N0742	72-14M-115	7	3535	C.I. / FG200	72	90	320.86	-	133	280	22	89	22	190	29.00
N0743	80-14M-115	7	3535	C.I. / FG200	80	90	356.51	-	133	315	22	89	22	190	32.00
N0744	90-14M-115	7	3535	C.I. / FG200	90	90	401.07	-	133	360	22	89	22	190	36.50
N0745	112-14M-115	8	3535	C.I. / FG200	112	90	499.11	-	133	157	22	89	22	190	46.00
N0746	144-14M-115	8	3535	C.I. / FG200	144	100	641.71	-	133	600	6.5	102	6.5	230	68.00
N0747	168-14M-115	8	4040	C.I. / FG200	168	100	748.66	-	133	706	6.5	102	6.5	230	82.60
N0748	192-14M-115	8	4040	C.I. / FG200	192	100	855.62	-	133	813	6.5	102	6.5	230	96.00

Please note all dimensions are in mm

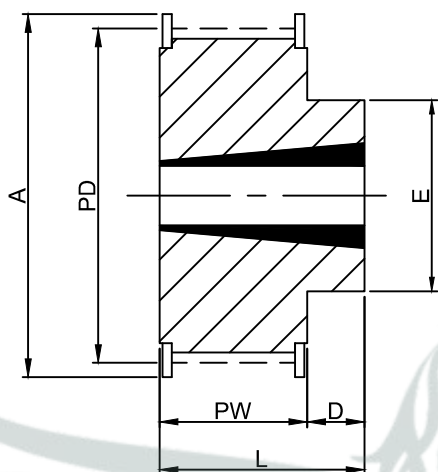

**TYPE 2F**

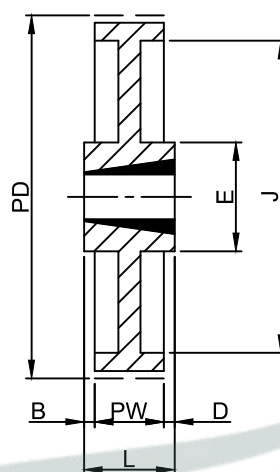

**TYPE 9**

## TECHNICAL SPECIFICATIONS

### 3/8" Pitch Pulley for 1/2" Wide belts. Ref. L050

PART NO.	PULLEY SIZE	PULLEY TYPE	BUSH NO	MATERIAL	NO. OF TEETH	MAX BORE (MB)	PD	A	PW	J	B	L	D	E	APPROX WEIGHT (kg)
N0835	18L050	2F	1108	C.I. / FG200	18	28	54.57	60	19	-	-	22	3	43	0.17
N0836	19L050	2F	1108	C.I. / FG200	19	28	57.61	64	19	-	-	22	3	43	0.20
N0837	20L050	2F	1108	C.I. / FG200	20	28	60.6	67	19	-	-	22	3	48	0.23
N0838	21L150	2F	1108	C.I. / FG200	21	28	63.67	70	19	-	-	22	3	48	0.30
N0839	22L050	2F	1108	C.I. / FG200	22	28	66.70	75	19	-	-	22	3	51	0.36
N0840	23L050	2F	1108	C.I. / FG200	23	28	69.73	79	19	-	-	22	3	54	0.41
N0841	24L050	2F	1108	C.I. / FG200	24	28	72.77	79	19	-	-	22	3	54	0.45
N0842	25L050	2F	1108	C.I. / FG200	25	28	75.80	83	19	-	-	22	3	56	0.50
N0843	26L050	2F	1108	C.I. / FG200	26	28	78.83	86	19	-	-	22	3	60	0.55
N0844	27L050	2F	1108	C.I. / FG200	27	28	81.86	86	19	-	-	22	3	62	0.61
N0845	28L050	2F	1108	C.I. / FG200	28	28	84.89	91	19	-	-	22	3	65	0.68
N0846	30L050	2F	1108	C.I. / FG200	30	28	90.96	98	19	-	-	22	3	70	0.82
N0847	32L050	2F	1108	C.I. / FG200	32	28	97.02	103	19	-	-	22	3	74	0.98
N0848	36L050	2F	1108	C.I. / FG200	36	28	109.15	115	19	-	-	22	3	85	1.38
N0849	40L050	2F	1610	C.I. / FG200	40	42	121.28	128	19	-	-	25	3	97	1.75
N0850	48L050	2F	1610	C.I. / FG200	48	42	145.53	151	19	120	6	25	6	88	1.76
N0851	60L050	9	1610	C.I. / FG200	60	42	181.91	-	19	165	3	25	3	92	2.18
N0852	72L050	9	1610	C.I. / FG200	72	42	218.30	-	19	202	3	25	3	92	3.00
N0853	84L050	9	1610	C.I. / FG200	84	42	254.68	-	19	238	3	25	3	92	4.00
N0854	96L050	9	2012	C.I. / FG200	96	50	291.06	-	19	275	6.5	32	6.5	106	5.50
N0855	120L050	9	2012	C.I. / FG200	120	50	363.83	-	19	344	6.5	32	6.5	106	6.80

Please note all dimensions are in mm

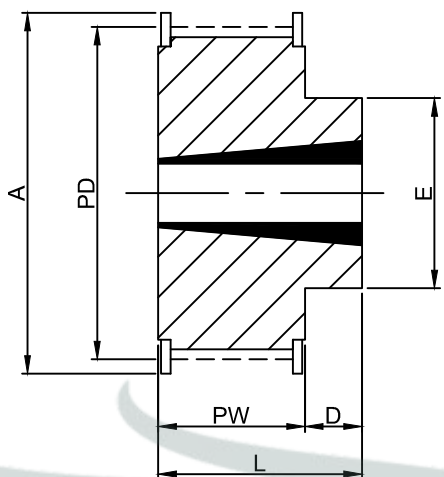

**TYPE 2F**

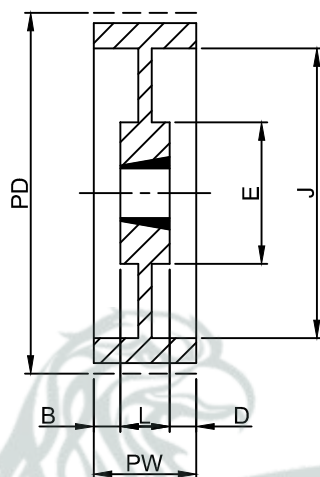

**TYPE 7**

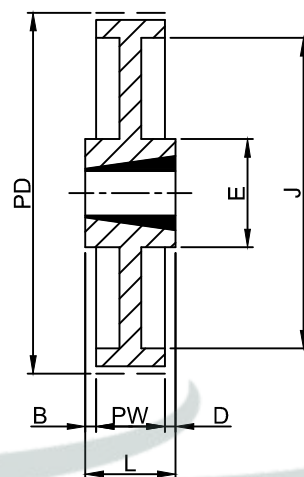

**TYPE 9**

## TECHNICAL SPECIFICATIONS

### 3/8" Pitch Pulley for 3/4" Wide belts. Ref. L075

PART NO.	PULLEY SIZE	PULLEY TYPE	BUSH NO	MATERIAL	NO. OF TEETH	MAX BORE (MB)	PD	A	PW	J	B	L	D	E	APPROX WEIGHT (kg)
N0856	18L075	2F	1108	C.I. / FG200	18	28	54.57	60	25	-	-	25	-	-	0.24
N0857	19L075	2F	1108	C.I. / FG200	19	28	57.61	64	25	-	-	25	-	-	0.28
N0858	20L075	2F	1108	C.I. / FG200	20	28	60.64	67	25	-	-	25	-	-	0.33
N0859	21L075	2F	1108	C.I. / FG200	21	28	63.67	70	25	-	-	25	-	-	0.38
N0860	22L075	2F	1108	C.I. / FG200	22	28	66.70	75	25	-	-	25	-	-	0.45
N0861	23L075	2F	1108	C.I. / FG200	23	28	69.73	79	25	-	-	25	-	-	0.52
N0862	24L075	2F	1108	C.I. / FG200	24	28	72.77	79	25	-	-	25	-	-	0.58
N0863	25L075	2F	1108	C.I. / FG200	25	28	75.80	83	25	-	-	25	-	-	0.64
N0864	26L075	2F	1108	C.I. / FG200	26	28	78.83	86	25	-	-	25	-	-	0.71
N0865	27L075	2F	1108	C.I. / FG200	27	28	81.86	86	25	-	-	25	-	-	0.79
N0866	28L075	2F	1108	C.I. / FG200	28	28	84.89	91	25	-	-	25	-	-	0.86
N0867	30L075	2F	1108	C.I. / FG200	30	28	90.96	98	25	-	-	25	-	-	1.04
N0868	32L075	2F	1108	C.I. / FG200	32	28	97.02	103	25	-	-	25	-	-	1.21
N0869	36L075	2F	1610	C.I. / FG200	36	42	109.15	115	25	-	-	25	-	-	1.41
N0870	40L075	2F	1610	C.I. / FG200	40	42	121.28	128	25	-	-	25	-	-	1.86
N0871	48L075	2F	1610	C.I. / FG200	48	42	145.53	151	25	120	-	25	-	92	2.50
N0872	60L075	7	1610	C.I. / FG200	60	42	181.91	-	25	166	-	25	-	92	3.00
N0873	72L075	7	1610	C.I. / FG200	72	42	218.30	-	25	202	-	25	-	92	4.00
N0874	84L075	9	2012	C.I. / FG200	84	50	254.68	-	25	236	3.5	32	3.5	106	5.20
N0875	96L075	9	2012	C.I. / FG200	96	50	291.06	-	25	270	3.5	32	3.5	106	6.50
N0876	120L075	9	2012	C.I. / FG200	120	50	363.83	-	25	343	3.5	32	3.5	106	7.60

Please note all dimensions are in mm

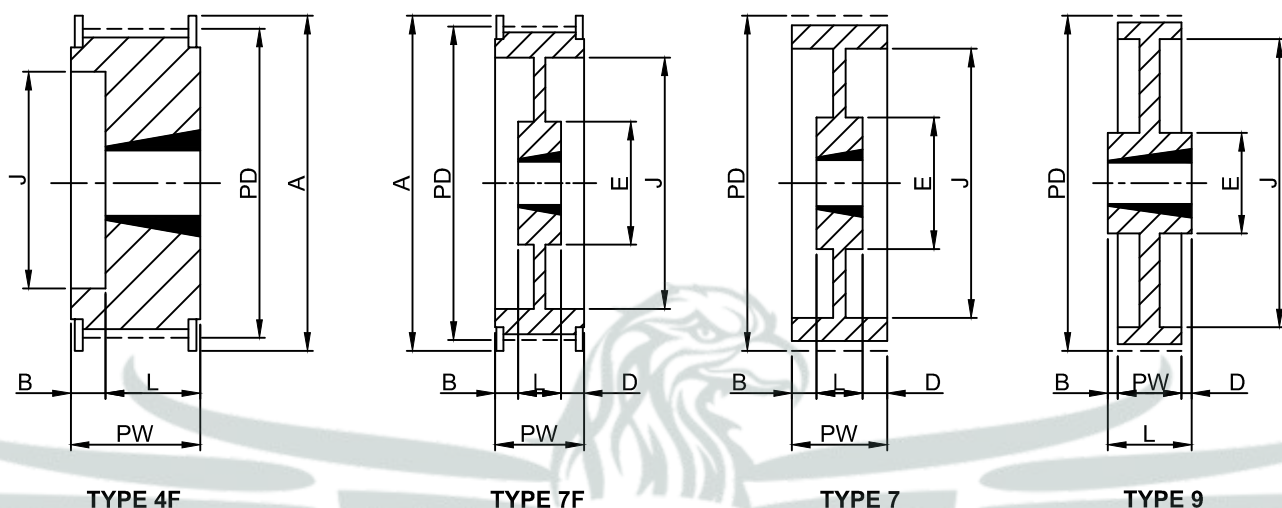

## TECHNICAL SPECIFICATIONS

### 3/8" Pitch Pulley for 1" Wide belts. Ref. L100

PART NO.	PULLEY SIZE	PULLEY TYPE	BUSH NO	MATERIAL	NO. OF TEETH	MAX BORE (MB)	PD	A	PW	J	B	L	D	E	APPROX WEIGHT (kg)
N0877	18L100	4F	1108	C.I. / FG200	18	28	54.57	60	32	38	10	22	-	-	0.25
N0878	19L100	4F	1108	C.I. / FG200	19	28	57.61	64	32	38	10	22	-	-	0.31
N0879	20L100	4F	1108	C.I. / FG200	20	28	60.64	67	32	45	10	22	-	-	0.36
N0880	21L100	4F	1108	C.I. / FG200	21	28	63.67	70	32	5	10	22	-	-	0.41
N0881	22L100	4F	1108	C.I. / FG200	22	28	66.70	75	32	48	10	22	-	-	0.47
N0882	23L100	4F	1108	C.I. / FG200	23	28	69.73	79	32	52	10	22	-	-	0.53
N0883	24L100	4F	1108	C.I. / FG200	24	28	72.77	79	32	52	10	22	-	-	0.60
N0884	25L100	4F	1108	C.I. / FG200	25	28	75.80	83	32	54	10	22	-	-	0.67
N0885	26L100	4F	1108	C.I. / FG200	26	28	78.83	86	32	60	10	22	-	-	0.73
N0886	27L100	4F	1108	C.I. / FG200	27	28	81.83	86	32	60	10	22	-	-	0.80
N0887	28L100	4F	1108	C.I. / FG200	28	28	87.89	91	32	65	10	22	-	-	0.87
N0888	30L100	4F	1210	C.I. / FG200	30	32	90.96	96	32	71	7	25	-	-	0.98
N0889	32L100	4F	1210	C.I. / FG200	32	32	97.02	103	32	75	7	25	-	-	1.18
N0890	36L100	4F	1210	C.I. / FG200	36	42	109.15	115	32	86	7	25	-	-	1.42
N0891	40L100	7F	1610	C.I. / FG200	40	42	121.28	128	32	96	3.5	25	3.5	90	1.70
N0892	48L100	7F	1610	C.I. / FG200	48	42	145.53	151	32	110	3.5	25	3.5	92	2.70
N0893	60L100	7	1610	C.I. / FG200	60	42	181.91	-	32	166	3.5	25	3.5	92	2.40
N0894	72L100	9	2012	C.I. / FG200	72	50	218.30	-	32	202	-	32	-	106	4.40
N0895	84L100	9	2012	C.I. / FG200	84	50	254.68	-	32	236	-	32	-	106	6.00
N0896	96L100	9	2012	C.I. / FG200	96	50	291.06	-	32	270	-	32	-	106	7.10
N0897	120L100	9	2012	C.I. / FG200	120	50	363.83	-	32	343	-	32	-	106	8.50

Please note all dimensions are in mm

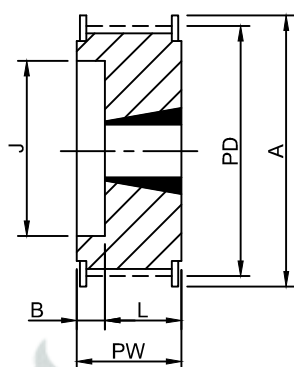

**TYPE 4F**

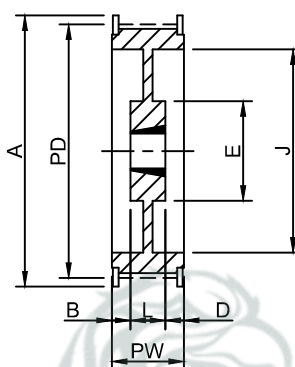

**TYPE 7F**

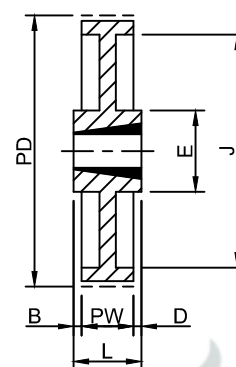

**TYPE 9**

## TECHNICAL SPECIFICATIONS

### 1/2" Pitch Pulley for 1" Wide belts. Ref. H100

PART NO.	PULLEY SIZE	PULLEY TYPE	BUSH NO	MATERIAL	NO. OF TEETH	MAX BORE (MB)	PD	A	PW	J	B	L	D	E	APPROX WEIGHT (kg)
N0749	16H100	4F	1108	C.I. / FG200	16	28	64.68	70	32	45	7	22	-	-	0.88
N0750	18H100	4F	1210	C.I. / FG200	18	32	72.77	79	32	52	7	25	-	-	1.06
N0751	19H100	4F	1210	C.I. / FG200	19	32	76.81	83	32	56	7	25	-	-	1.23
N0752	20H100	4F	1210	C.I. / FG200	20	32	80.95	87	32	60	7	25	-	-	1.33
N0753	21H100	4F	1210	C.I. / FG200	21	32	84.89	91	32	64	7	25	-	-	1.43
N0754	22H100	4F	1210	C.I. / FG200	22	32	88.94	95	32	67	7	25	-	-	1.63
N0755	23H100	4F	1610	C.I. / FG200	23	42	92.98	98	32	70	7	25	-	-	1.85
N0756	24H100	4F	1610	C.I. / FG200	24	42	97.02	103	32	74	7	25	-	-	1.93
N0757	25H100	4F	1610	C.I. / FG200	25	42	101.06	106	32	77	7	25	-	-	2.07
N0758	26H100	4F	1610	C.I. / FG200	26	42	105.11	112	32	82	7	25	-	-	2.30
N0759	27H100	4F	1610	C.I. / FG200	27	42	109.15	115	32	85	7	25	-	-	2.40
N0760	28H100	4F	1610	C.I. / FG200	28	42	113.19	120	32	90	7	25	-	-	2.53
N0761	30H100	4F	1610	C.I. / FG200	30	42	121.28	128	32	98	7	25	-	-	2.93
N0762	32H100	7F	1610	C.I. / FG200	32	42	129.36	135	32	106	3.5	25	3.5	80	3.06
N0763	36H100	7F	1610	C.I. / FG200	36	42	145.53	151	32	121	3.5	25	3.5	92	3.92
N0764	40H100	7F	1610	C.I. / FG200	40	42	161.70	168	32	138	3.5	25	3.5	92	4.95
N0765	44H100	7F	2012	C.I. / FG200	44	50	177.87	184	32	152	-	32	-	106	6.92
N0766	48H100	7F	2012	C.I. / FG200	48	50	194.04	200	32	169	-	32	-	106	5.30
N0767	60H100	9	2012	C.I. / FG200	60	50	242.55	-	32	223	-	32	-	119	7.50
N0768	72H100	9	2012	C.I. / FG200	72	50	291.06	-	32	270	-	32	-	119	9.00
N0769	84H100	9	2012	C.I. / FG200	84	50	339.57	-	32	318	-	32	-	106	10.00
N0770	96H100	9	2517	C.I. / FG200	96	60	388.08	-	34	366	5.5	45	5.5	119	13.80
N0771	120H100	9	2517	C.I. / FG200	120	60	485.10	-	34	462	5.5	45	5.5	119	22.00

Please note all dimensions are in mm

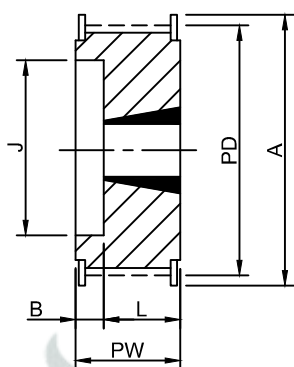

**TYPE 4F**

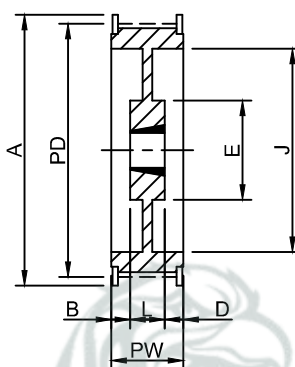

**TYPE 7F**

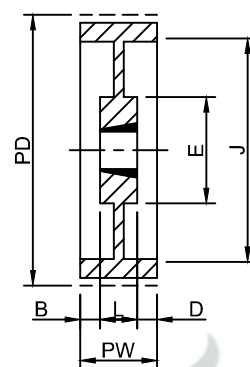

**TYPE 7**

## TECHNICAL SPECIFICATIONS

### 1/2" Pitch Pulley for 1 1/2" Wide belts. Ref. H150

PART NO.	PULLEY SIZE	PULLEY TYPE	BUSH NO	MATERIAL	NO. OF TEETH	MAX BORE (MB)	PD	A	PW	J	B	L	D	E	APPROX WEIGHT (kg)
N0772	18H150	4F	1210	C.I. / FG200	18	32	72.77	79	45	52	20	25	-	-	1.45
N0773	19H150	4F	1210	C.I. / FG200	19	32	76.81	83	45	56	20	25	-	-	1.55
N0774	20H150	4F	1210	C.I. / FG200	20	32	80.95	87	45	60	20	25	-	-	1.70
N0775	21H150	4F	1210	C.I. / FG200	21	32	84.89	91	45	64	20	25	-	-	1.87
N0776	22H150	4F	1210	C.I. / FG200	22	32	88.94	95	45	67	20	25	-	-	2.07
N0777	23H150	4F	1610	C.I. / FG200	23	42	92.98	98	5	70	20	25	-	-	2.28
N0778	24H150	4F	1610	C.I. / FG200	24	42	97.02	103	45	74	20	25	-	-	2.50
N0779	25H150	4F	1610	C.I. / FG200	25	42	101.06	106	45	77	20	25	-	-	2.71
N0780	26H150	4F	1610	C.I. / FG200	26	42	105.11	112	45	82	20	25	-	-	2.99
N0781	27H150	4F	1610	C.I. / FG200	27	42	109.15	115	45	85	20	25	-	-	3.15
N0782	28H150	4F	1610	C.I. / FG200	28	42	113.19	120	45	91	20	25	-	-	3.39
N0783	30H150	4F	1610	C.I. / FG200	30	42	121.28	128	45	98	20	25	-	-	3.86
N0784	32H150	7F	1610	C.I. / FG200	32	42	129.36	135	45	106	10	25	10	80	4.37
N0785	36H150	7F	1610	C.I. / FG200	36	42	145.53	151	45	121	10	25	10	92	5.50
N0786	40H150	7F	1610	C.I. / FG200	40	42	161.70	168	45	138	10	25	10	92	6.80
N0787	44H150	7F	2012	C.I. / FG200	44	50	177.87	184	45	152	6.5	32	6.5	92	8.50
N0788	48H150	7F	2012	C.I. / FG200	48	50	194.04	200	45	169	6.5	32	6.5	106	8.80
N0789	60H150	7	2012	C.I. / FG200	60	50	242.55	-	46	223	7	32	7	106	9.00
N0790	72H150	7	2012	C.I. / FG200	72	50	291.06	-	46	270	7	32	7	106	11.00
N0791	84H150	7	2012	C.I. / FG200	84	50	339.57	-	46	320	7	32	7	106	13.00
N0792	96H150	7	2517	C.I. / FG200	96	60	388.08	-	45	366	-	45	-	119	17.00
N0793	120H150	7	2517	C.I. / FG200	120	60	485.10	-	45	462	-	45	-	119	25.00

Please note all dimensions are in mm



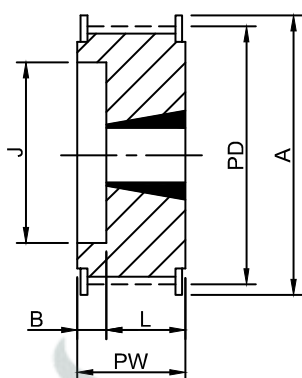

**TYPE 4F**

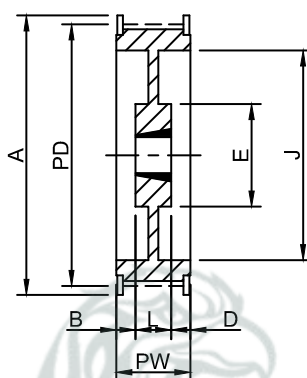

**TYPE 7F**

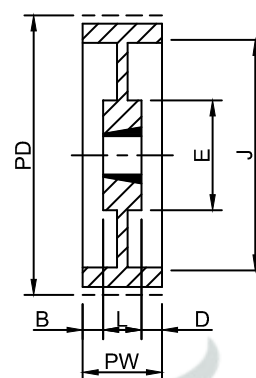

**TYPE 7**

## TECHNICAL SPECIFICATIONS

### 1/2" Pitch Pulley for 2" Wide belts. Ref. H200

PART NO.	PULLEY SIZE	PULLEY TYPE	BUSH NO	MATERIAL	NO. OF TEETH	MAX BORE (MB)	PD	A	PW	J	B	L	D	E	APPROX WEIGHT (kg)
N0794	18H200	4F	1210	C.I. / FG200	18	32	72.77	79	58	52	33	25	-	-	1.65
N0795	19H200	4F	1210	C.I. / FG200	19	32	76.81	83	58	56	33	25	-	-	1.90
N0796	20H200	4F	1610	C.I. / FG200	20	42	80.95	87	58	60	33	25	-	-	2.11
N0797	21H200	4F	1610	C.I. / FG200	21	42	84.89	91	58	64	33	25	-	-	2.23
N0798	22H200	4F	1610	C.I. / FG200	22	42	88.94	95	58	67	33	25	-	-	2.45
N0799	23H200	4F	1610	C.I. / FG200	23	42	92.98	98	58	70	33	25	-	-	2.71
N0800	24H200	4F	1610	C.I. / FG200	24	42	97.02	103	58	74	33	25	-	-	2.97
N0801	25H200	4F	1610	C.I. / FG200	25	42	101.06	106	58	77	33	25	-	-	3.32
N0802	26H200	4F	1610	C.I. / FG200	26	42	105.11	112	58	82	33	25	-	-	3.61
N0803	27H200	4F	1610	C.I. / FG200	27	42	109.15	115	58	85	33	25	-	-	3.90
N0804	28H200	4F	1610	C.I. / FG200	28	42	113.19	120	58	91	33	25	-	-	4.10
N0805	30H200	4F	1610	C.I. / FG200	30	42	121.28	128	58	98	33	25	-	-	4.74
N0806	32H200	4F	1610	C.I. / FG200	32	50	129.36	135	58	106	26	32	-	-	5.60
N0807	36H200	7F	2012	C.I. / FG200	36	50	145.53	151	58	121	13	32	13	102	7.10
N0808	40H200	7F	2012	C.I. / FG200	40	50	161.70	168	58	138	13	32	13	106	8.40
N0809	44H200	7F	2012	C.I. / FG200	44	60	177.87	184	58	150	13	32	13	106	10.50
N0810	48H200	7F	2517	C.I. / FG200	48	60	194.04	200	58	169	6.5	45	6.5	119	8.60
N0811	60H200	7	2517	C.I. / FG200	60	60	242.55	-	60	223	7.5	45	7.5	119	11.00
N0812	72H200	7	2517	C.I. / FG200	72	60	291.06	-	60	270	7.5	45	7.5	119	14.00
N0813	84H200	7	2517	C.I. / FG200	84	60	339.57	-	60	320	7.5	45	7.5	119	15.00
N0814	96H200	7	2517	C.I. / FG200	96	60	388.08	-	60	366	7.5	45	7.5	119	20.30
N0815	120H200	7	2517	C.I. / FG200	120	60	485.10	-	60	462	7.5	45	7.5	119	28.00

Please note all dimensions are in mm

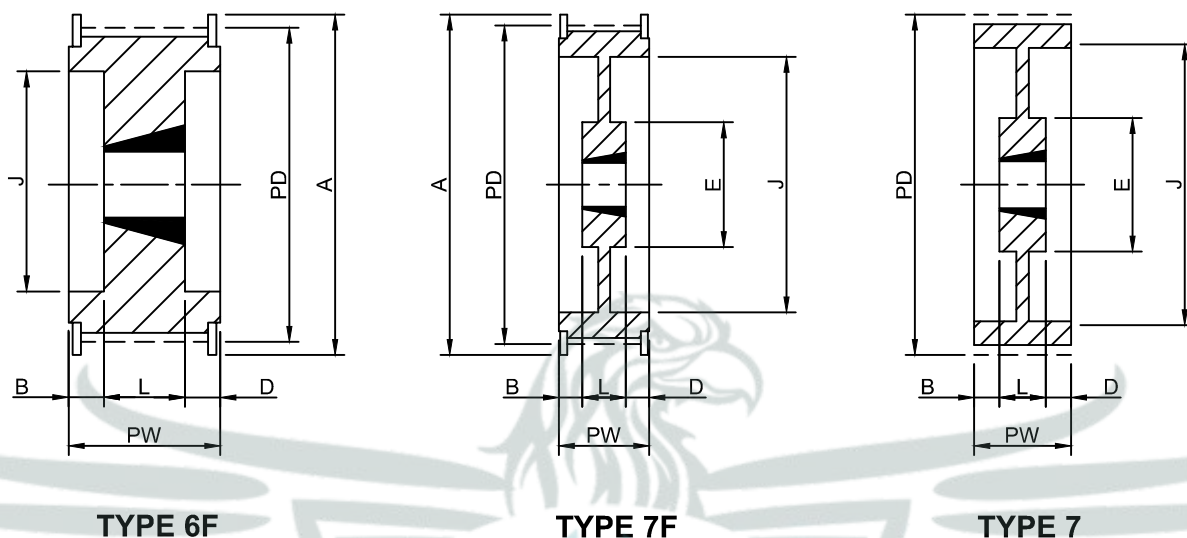

## TECHNICAL SPECIFICATIONS

### 1/2" Pitch Pulley for 3" Wide belts. Ref. H300

PART NO.	PULLEY SIZE	PULLEY TYPE	BUSH NO	MATERIAL	NO. OF TEETH	MAX BORE (MB)	PD	A	PW	J	B	L	D	E	APPROX WEIGHT (kg)
N0816	20H300	6F	1615	C.I. / FG300	20	42	80.95	87	84	60	23	38	23	-	3.10
N0817	21H300	6F	1615	C.I. / FG300	21	42	84.89	91	84	64	23	38	23	-	3.32
N0818	22H300	6F	1615	C.I. / FG300	22	42	88.94	95	84	67	23	38	23	-	3.67
N0819	23H300	6F	1615	C.I. / FG300	23	42	92.87	98	84	70	23	38	23	-	4.00
N0820	24H300	6F	1615	C.I. / FG300	24	42	97.02	103	84	74	23	38	23	-	4.40
N0821	25H300	6F	1615	C.I. / FG300	25	42	101.06	106	84	77	23	38	23	-	4.79
N0822	26H300	6F	1615	C.I. / FG300	26	42	105.11	112	84	82	23	38	23	-	5.20
N0823	27H300	6F	2012	C.I. / FG300	27	50	109.15	115	84	85	26	32	26	-	5.40
N0824	28H300	6F	2012	C.I. / FG300	28	50	113.19	120	84	91	26	32	26	-	5.60
N0825	30H300	6F	2012	C.I. / FG300	30	50	121.28	128	84	98	26	32	26	-	7.00
N0826	32H300	6F	2517	C.I. / FG300	32	60	129.36	135	84	106	19.5	45	19.5	-	7.80
N0827	36H300	6F	2517	C.I. / FG300	36	60	155.3	151	84	121	19.5	45	19.5	-	9.90
N0828	40H300	6F	2517	C.I. / FG300	40	60	161.70	168	84	138	19.5	45	19.5	-	12.20
N0829	48H300	7F	2517	C.I. / FG300	48	60	194.04	184	86	169	19.5	45	19.5	119	11.40
N0830	60H300	7	2517	C.I. / FG300	60	60	242.55	200	86	223	19.5	45	19.5	119	13.30
N0831	72H300	7	2517	C.I. / FG300	72	60	291.06	-	86	270	19.5	45	19.5	119	19.00
N0832	84H300	7	2517	C.I. / FG300	84	60	339.57	-	86	320	19.5	45	19.5	119	20.00
N0833	96H300	7	3030	C.I. / FG300	96	75	388.08	-	86	366	5	76	5	150	27.00
N0834	120H300	7	3030	C.I. / FG300	120	75	485.10	-	86	462	5	76	5	150	33.0

Please note all dimensions are in mm



## **AVM TIMING PULLEY PVT. LTD.**

*(formerly known as Ultrahigh (india) Engineers)*

📍 60, Vishala Estate (East), Nr. Madhuran Estate,  
Kathwada Ring Road, Odhav, Ahmedabad - 382415. (Gujarat), India

📞 Mr.Amit Patel +91 9327595211

📞 +91 93275 95211 | +91 98980 98434

✉️ amitptp@gmail.com | info@timingpulleyindia.com

🌐 [www.avmtimingpulley.com](http://www.avmtimingpulley.com)